

Annex A

Locations of Air Quality and Noise Monitoring Stations

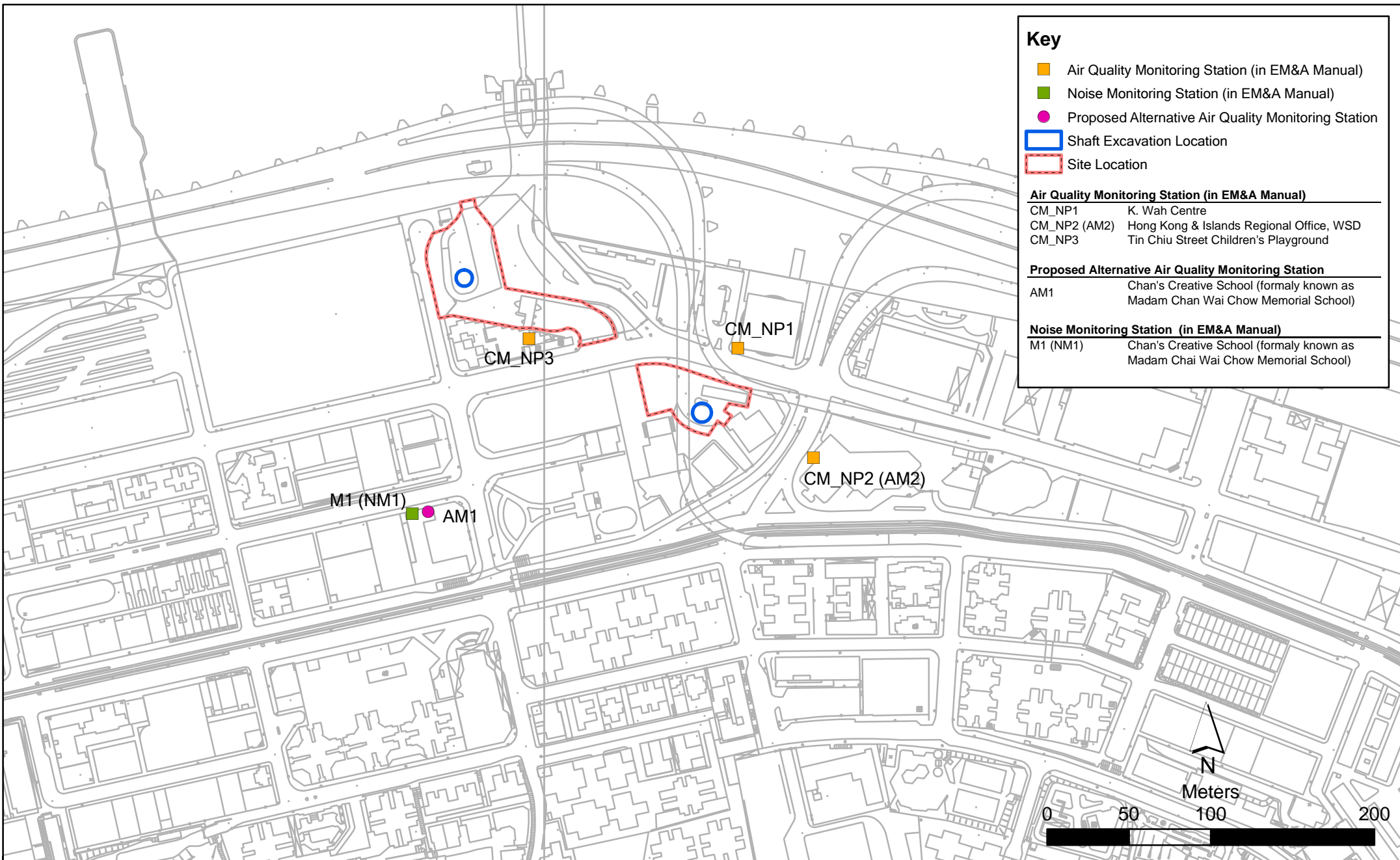

Figure 1

Contract No. DC/2007/23
 Harbour Area Treatment Scheme Stage 2A
 Construction of Sewage Conveyance System from North Point to Stonecutters Island
Baseline Air Quality & Noise Monitoring Stations (North Point)

Environmental
 Resources
 Management



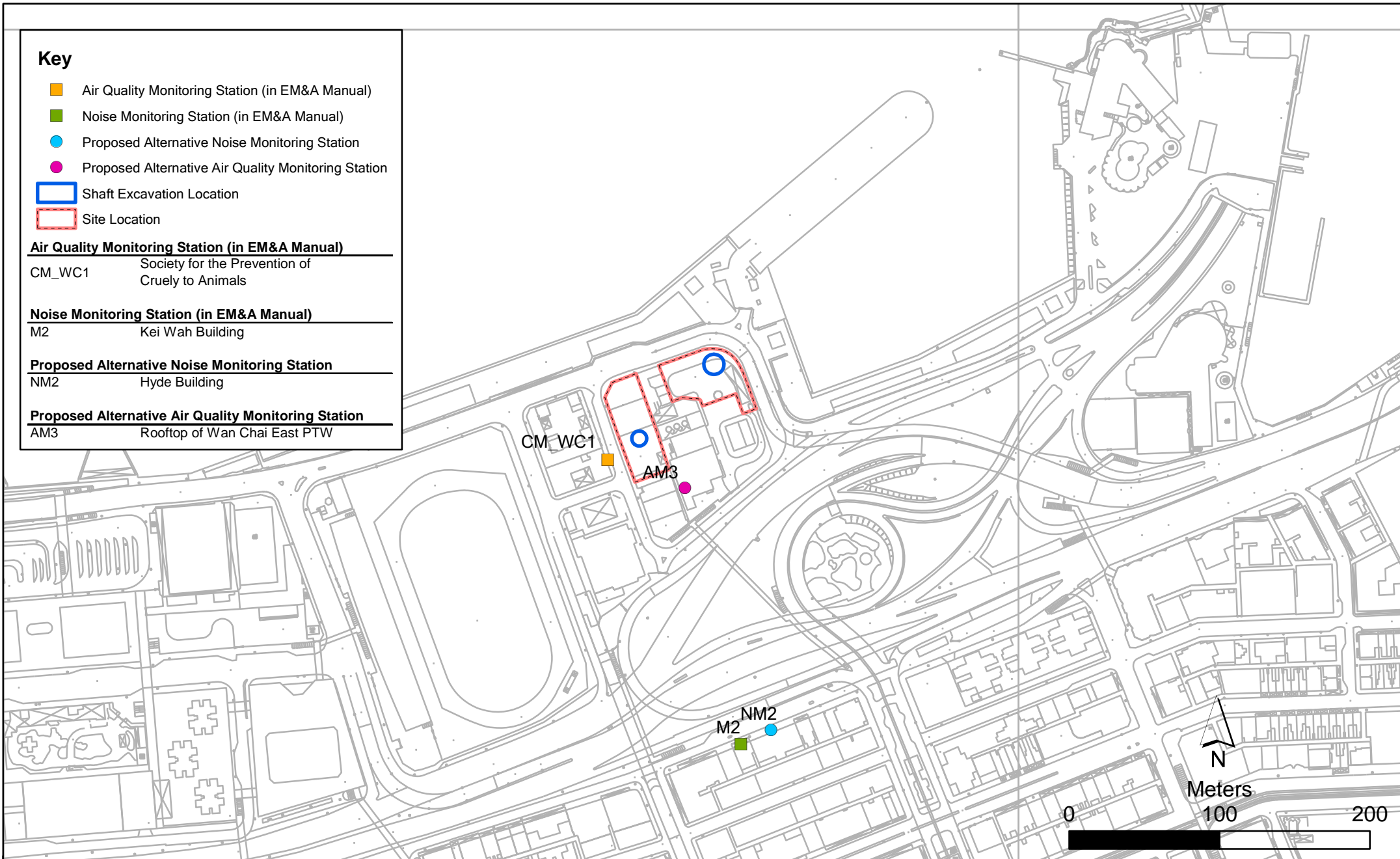

Figure 2

Contract No. DC/2007/23
 Harbour Area Treatment Scheme Stage 2A
 Construction of Sewage Conveyance System from North Point to Stonecutters Island
Baseline Air Quality & Noise Monitoring Stations (Wan Chai East)

File: EM&A and proposed station\0104887_Wan Chai.mxd
 Date: 16/10/2009

Environmental
 Resources
 Management



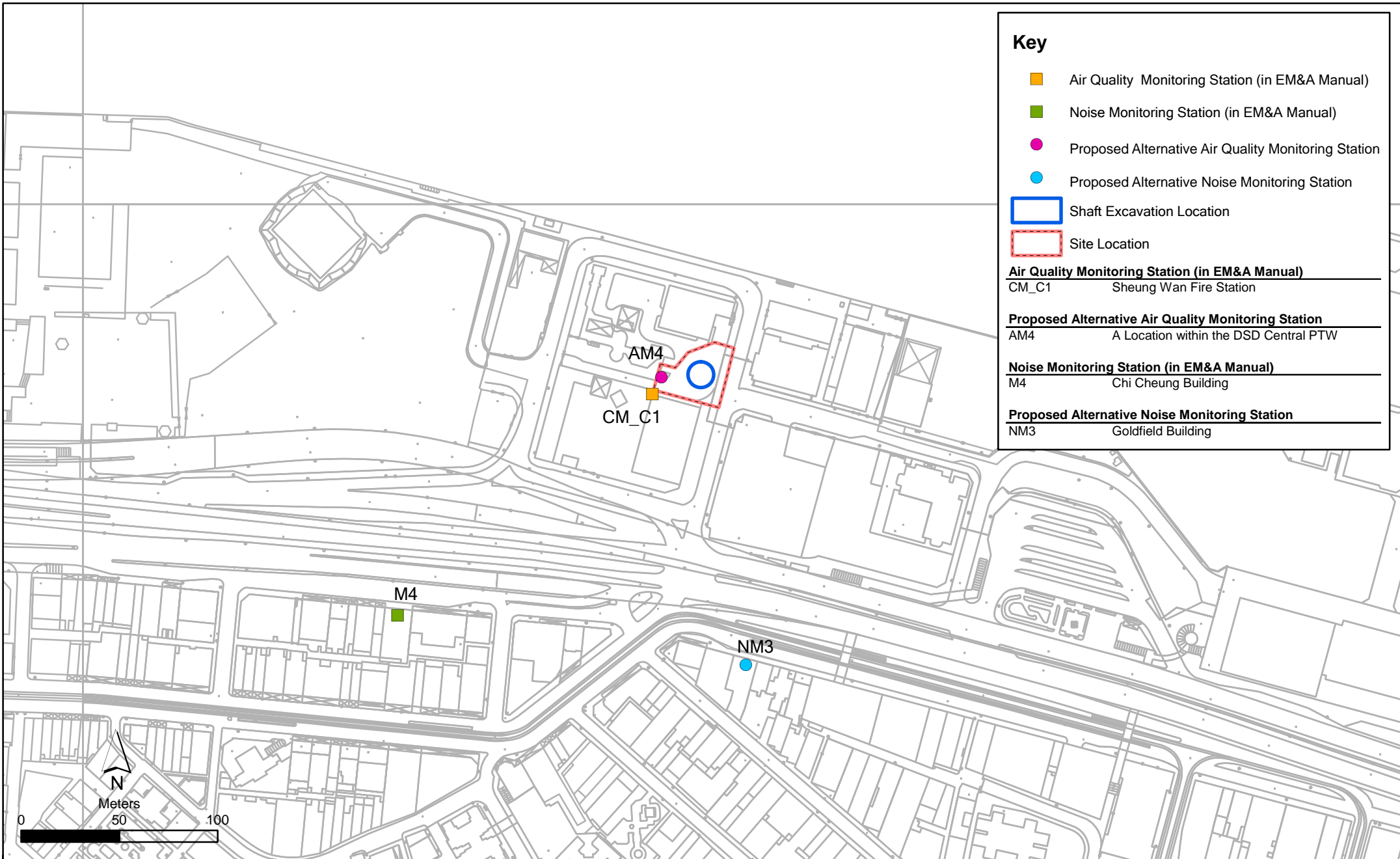
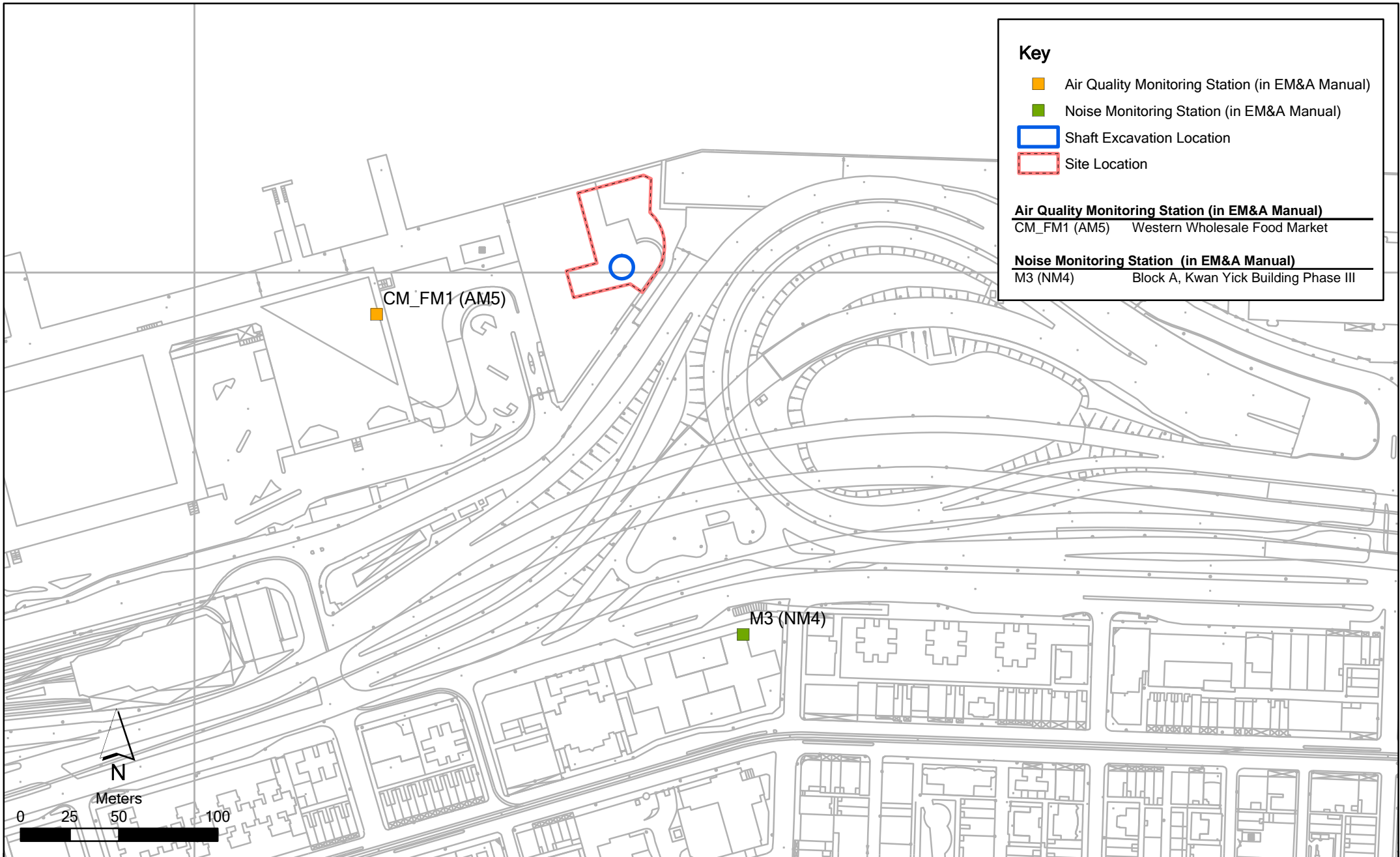

Figure 3

Contract No. DC/2007/23
 Harbour Area Treatment Scheme Stage 2A
 Construction of Sewage Conveyance System from North Point to Stonecutters Island
Baseline Air Quality & Noise Monitoring Station (Central)

File: EM&A and proposed station\0104887_Central.mxd
 Date: 16/10/2009



Key

- Air Quality Monitoring Station (in EM&A Manual)
- Noise Monitoring Station (in EM&A Manual)
- Shaft Excavation Location
- Site Location

Air Quality Monitoring Station (in EM&A Manual)
 CM_FM1 (AM5) Western Wholesale Food Market

Noise Monitoring Station (in EM&A Manual)
 M3 (NM4) Block A, Kwan Yick Building Phase III

Figure 4

Contract No. DC/2007/23
 Harbour Area Treatment Scheme Stage 2A
 Construction of Sewage Conveyance System from North Point to Stonecutters Island
Baseline Air Quality & Noise Monitoring Station (Fung Mat Road)

**Environmental
 Resources
 Management**



File: EM&A and proposed station\0104887_Sai Ying Pun.mxd
 Date: 16/10/2009

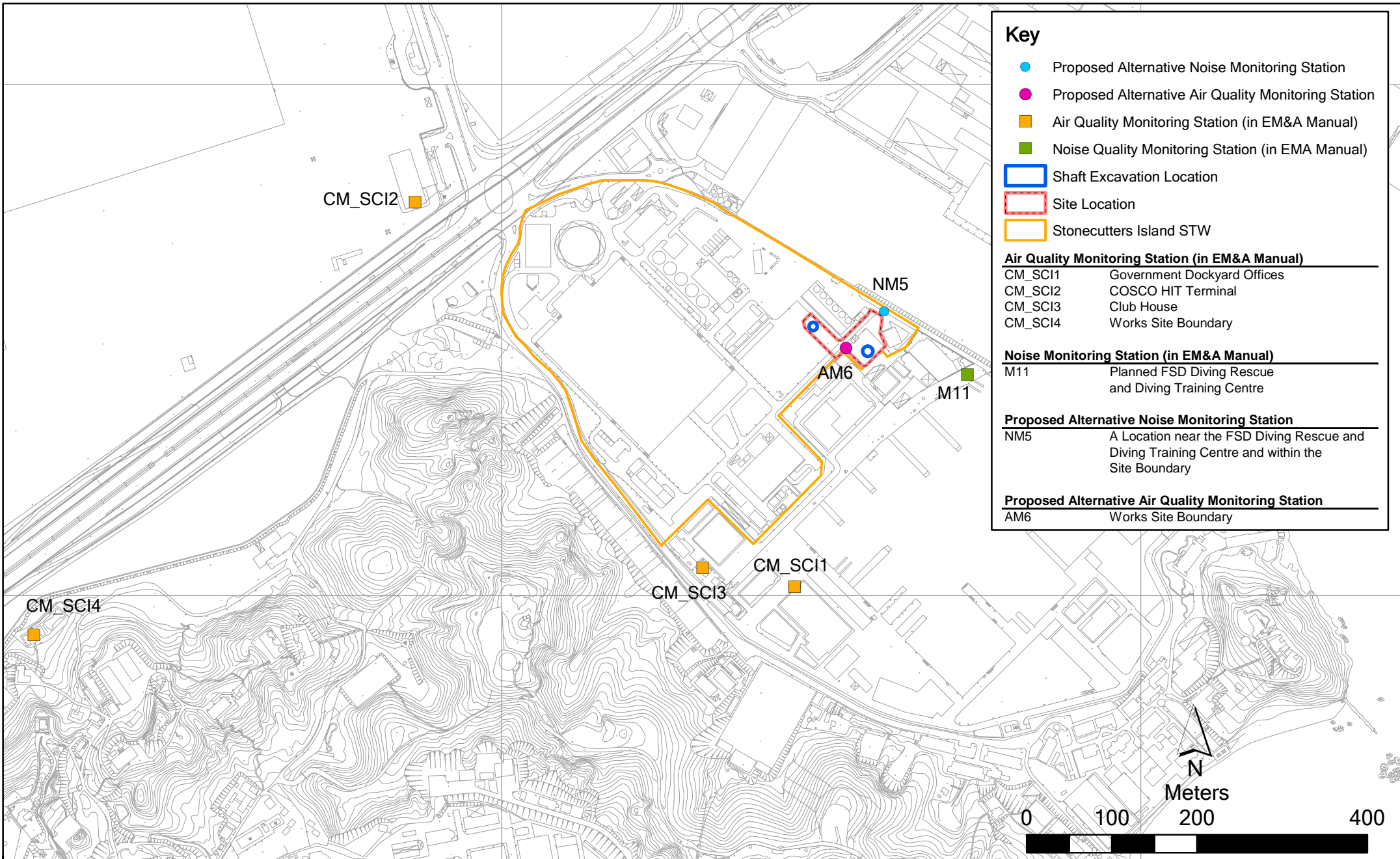

Figure 5

Contract No. DC/2007/23
 Harbour Area Treatment Scheme Stage 2A
 Construction of Sewage Conveyance System from North Point to Stonecutters Island
Baseline Air Quality Monitoring Station (Stonecutters Island STW)

File: EM&A and proposed station\0104887_Stonecutters Island.mxd
 Date: 16/10/2009

Environmental
 Resources
 Management





AM1 – Chan’s Creative School



AM2 - Rooftop of Hong Kong & Islands Regional Office, WSD



AM3 – Rooftop on DSD Wan Chai East PTW



AM4 – Location within DSD Central PTW



AM5 – AFCD Western Wholesale Food Market



AM6 – Site Boundary at Stonecutters Island Work Site



NM1 – Chan's Creative School



NM2 – Hyde Building

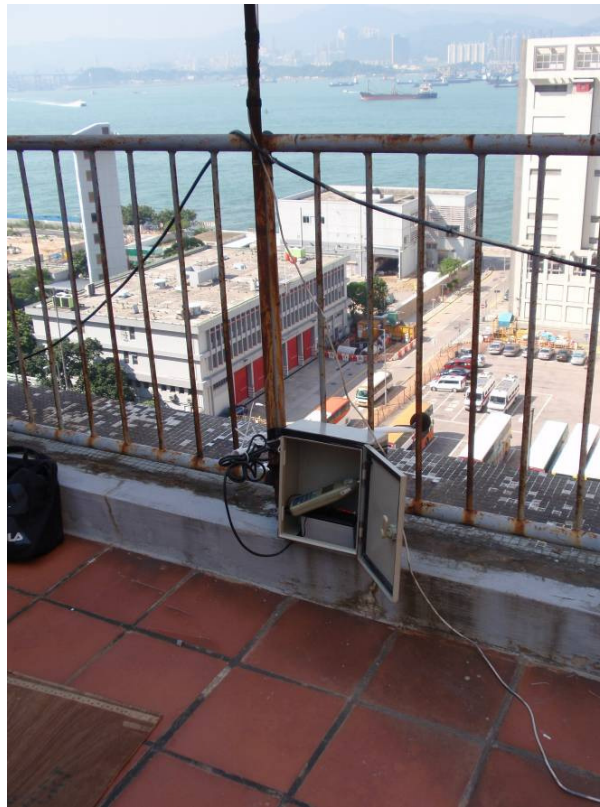

NM3 – Goldfield Building



NM4 – Kwan Yick Building Phase III



NM5 – A Location near the FSD Diving Rescue and Diving Training Centre near the Site Boundary